

# APPENDIX C

## Utilities Information

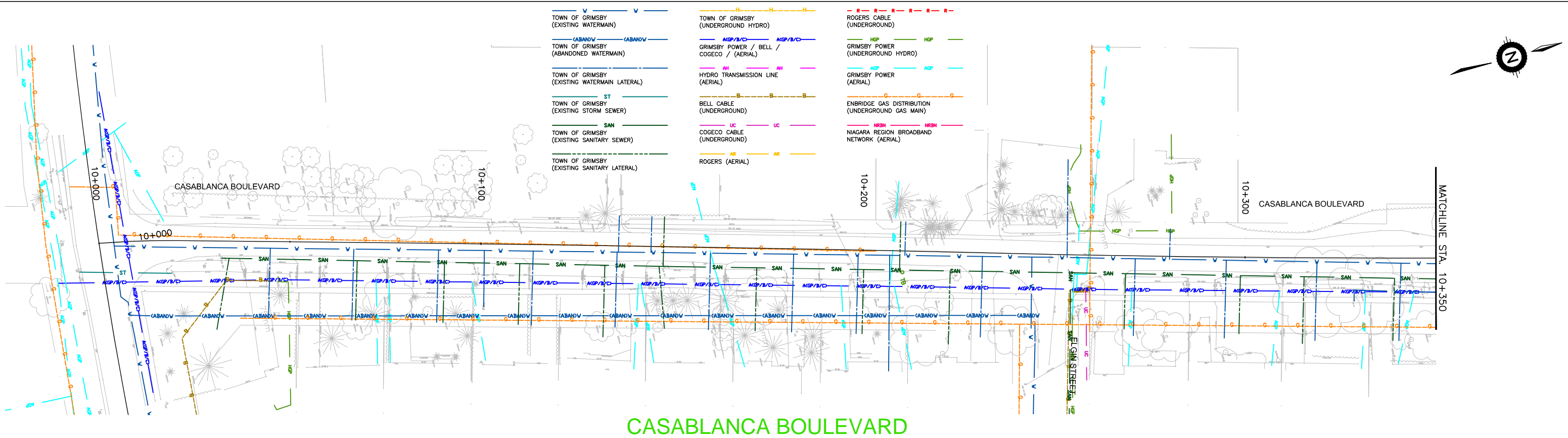

CASABLANCA BOULEVARD

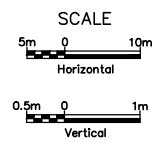
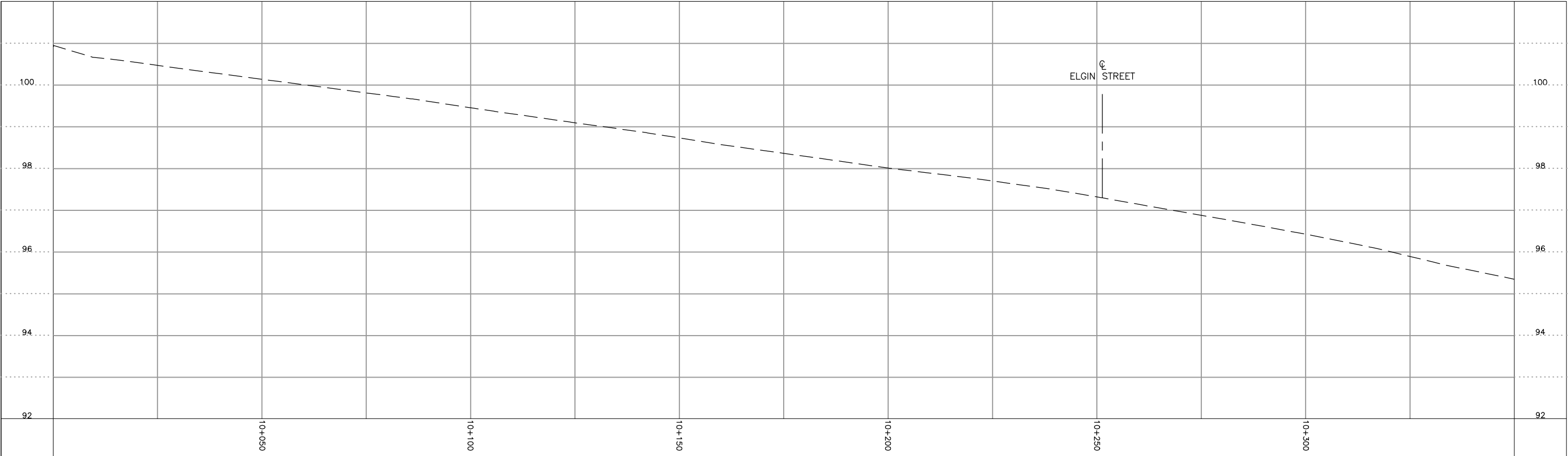

NO.	REVISION	DATE	INIT.
0	ISSUED FOR	YYYY-MM-DD	XXX

NOTES/LEGEND  
1 THE POSITION OF POLE LINES, CONDUITS, WATERMAINS, SEWER AND OTHER UNDERGROUND UTILITIES AND STRUCTURES IS NOT NECESSARILY SHOWN ON THE CONTRACT DRAWINGS AND, WHERE SHOWN, THE ACCURACY OF THE POSITION OF SUCH UTILITIES AND STRUCTURES IS NOT GUARANTEED. BEFORE STARTING WORK, THE CONTRACTOR SHALL INFORM HIMSELF OF THE EXACT LOCATION OF ALL SUCH UTILITIES AND STRUCTURES AND SHALL ASSUME ALL LIABILITY FOR DAMAGE TO THEM.  
2 PROPERTY LINES WERE PLOTTED USING REGISTERED PLANS AND BARS LOCATED IN THE FIELD. TO VERIFY THE ACCURACY OF THESE PROPERTY LINES, A LEGAL SURVEY SHOULD BE PERFORMED PRIOR TO CONSTRUCTION.

DRAFTING  
BDL  
DESIGN  
SMP  
CHECKED BY  
SMP  
APPROVED BY  
PAM



CONSULTANT FILE No. 18-7650	
DATE 2018-10-11	
SCALE AS SHOWN	
REF. No. #	
DWG No. 1	REV. 0

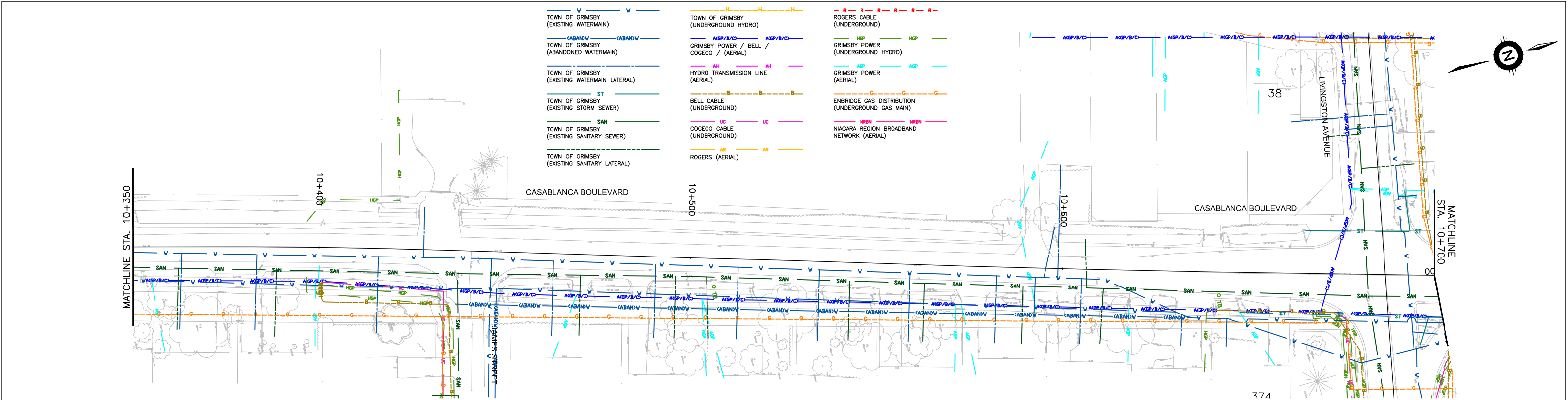

CASABLANCA BOULEVARD

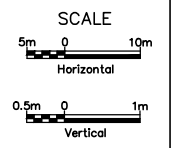
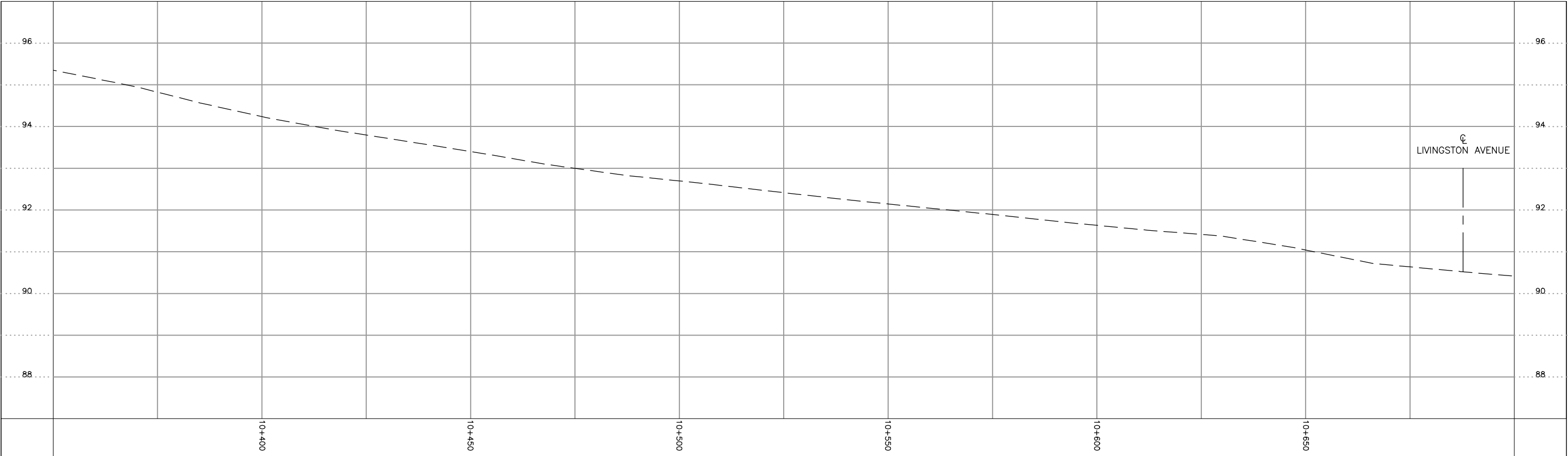

<b>NOTES/LEGEND</b> 1 THE POSITION OF POLE LINES, CONDUITS, WATERMAINS, SEWER AND OTHER UNDERGROUND AND OVERGROUND UTILITIES AND STRUCTURES IS NOT NECESSARILY SHOWN ON THE CONTRACT DRAWINGS AND, WHERE SHOWN, THE ACCURACY OF THE POSITION OF SUCH UTILITIES AND STRUCTURES IS NOT GUARANTEED. BEFORE STARTING WORK, THE CONTRACTOR SHALL INFORM HIMSELF OF THE EXACT LOCATION OF ALL SUCH UTILITIES AND STRUCTURES AND SHALL ASSUME ALL LIABILITY FOR DAMAGE TO THEM. 2 PROPERTY LINES WERE PLOTTED USING REGISTERED PLANS AND BARS LOCATED IN THE FIELD. TO VERIFY THE ACCURACY OF THESE PROPERTY LINES, A LEGAL SURVEY SHOULD BE PERFORMED PRIOR TO CONSTRUCTION.				<b>DRAFTING</b> BDL <b>DESIGN</b> SMP <b>CHECKED BY</b> SMP <b>APPROVED BY</b> PAM		<b>Niagara Region</b> <b>PUBLIC WORKS</b>		<b>DILLON CONSULTING</b>		<b>CASABLANCA BOULEVARD</b> <b>STA. 10+350 TO STA. 10+700</b> <b>TOWN OF GRIMSBY</b> <b>COMPOSITE UTILITY PLAN</b>		<b>CONSULTANT FILE No. 18-7650</b> <b>DATE 2018-10-11</b> <b>SCALE AS SHOWN</b> <b>REF. No. #</b> <b>DWG No. 2</b> <b>REV. 0</b>	
<b>REVISION</b> 0 ISSUED FOR YYYYY-MM-DD XXX NO. REVISION DATE INIT.													

DRAWING FILE: C:\project\working directory\projects 2018\20emp\dms29653\187650 - Composite Utility Plan.dwg PLOTTED: Nov 13, 2018 - 2:47pm PLOTTED BY: 20SMP

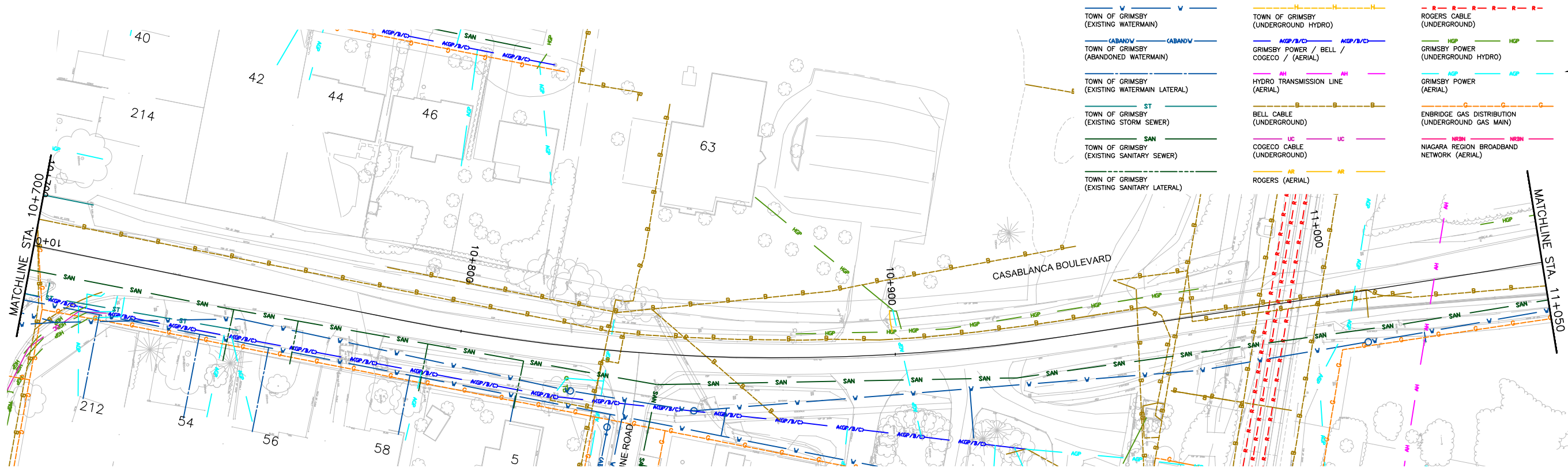

CASABLANCA BOULEVARD

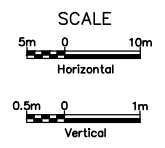
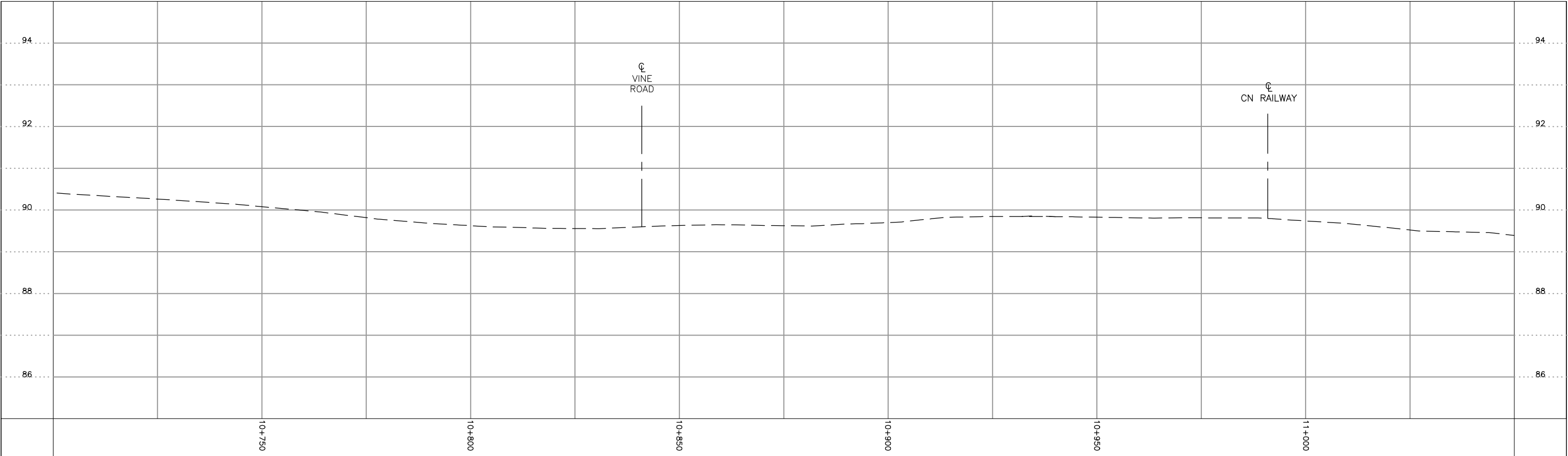

NOTES/LEGEND			
1 THE POSITION OF POLE LINES, CONDUITS, WATERMAINS, SEWER AND OTHER UNDERGROUND AND OVERGROUND UTILITIES AND STRUCTURES IS NOT NECESSARILY SHOWN ON THE CONTRACT DRAWINGS AND, WHERE SHOWN, THE ACCURACY OF THE POSITION OF SUCH UTILITIES AND STRUCTURES IS NOT GUARANTEED. BEFORE STARTING WORK, THE CONTRACTOR SHALL INFORM HIMSELF OF THE EXACT LOCATION OF ALL SUCH UTILITIES AND STRUCTURES AND SHALL ASSUME ALL LIABILITY FOR DAMAGE TO THEM.			
2 PROPERTY LINES WERE PLOTTED USING REGISTERED PLANS AND BARS LOCATED IN THE FIELD. TO VERIFY THE ACCURACY OF THESE PROPERTY LINES, A LEGAL SURVEY SHOULD BE PERFORMED PRIOR TO CONSTRUCTION.			
0	ISSUED FOR	YYYY-MM-DD	XXX
NO.	REVISION	DATE	INIT.

DRAFTING			
BDL			
DESIGN			
SMP			
CHECKED BY			
SMP			
APPROVED BY			
PAM			



CONSULTANT FILE No. 18-7650			
DATE 2018-10-11			
SCALE AS SHOWN			
REF. No. #			
DWG No. 3		REV. 0	



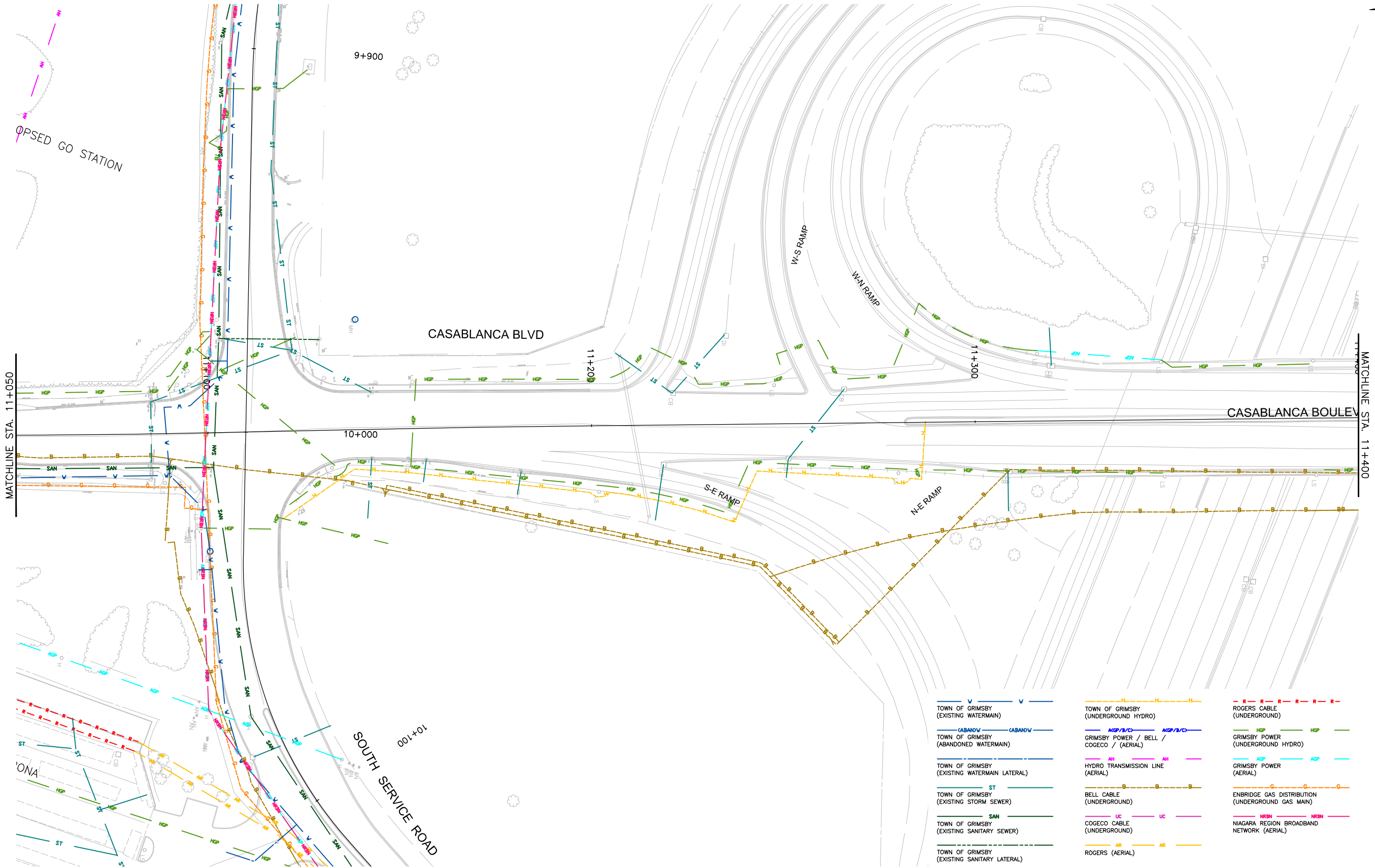

CASABLANCA BOULEVARD

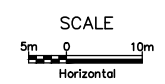

NO.	REVISION	DATE	INIT.
0	ISSUED FOR	YYYY-MM-DD	XXX

NOTES/LEGEND  
1 THE POSITION OF POLE LINES, CONDUITS, WATERMAINS, SEWER AND OTHER UNDERGROUND AND OVERGROUND UTILITIES AND STRUCTURES IS NOT NECESSARILY SHOWN ON THE CONTRACT DRAWINGS AND, WHERE SHOWN, THE ACCURACY OF THE POSITION OF SUCH UTILITIES AND STRUCTURES IS NOT GUARANTEED. BEFORE STARTING WORK, THE CONTRACTOR SHALL INFORM HIMSELF OF THE EXACT LOCATION OF ALL SUCH UTILITIES AND STRUCTURES AND SHALL ASSUME ALL LIABILITY FOR DAMAGE TO THEM.  
2 PROPERTY LINES WERE PLOTTED USING REGISTERED PLANS AND BARS LOCATED IN THE FIELD. TO VERIFY THE ACCURACY OF THESE PROPERTY LINES, A LEGAL SURVEY SHOULD BE PERFORMED PRIOR TO CONSTRUCTION.

DRAFTING	BDL
DESIGN	SMP
CHECKED BY	SMP
APPROVED BY	PAM



CASABLANCA BOULEVARD  
STA. 11+050 TO STA. 11+400  
TOWN OF GRIMSBY  
COMPOSITE UTILITY PLAN

CONSULTANT FILE No. 18-7650	
DATE 2018-10-09	
SCALE AS SHOWN	
REF. No. #	
DWG No. 4A	REV. 0

CASABLANCA BOULEVARD

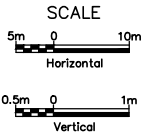
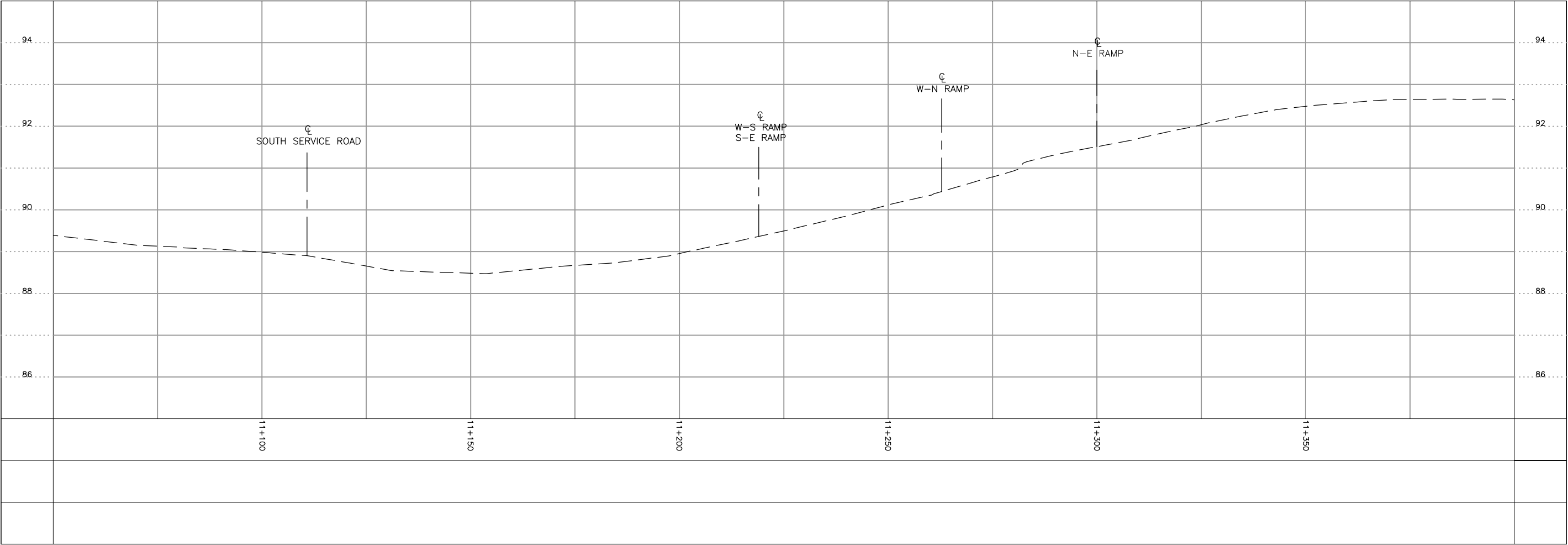

0	ISSUED FOR	YYYY-MM-DD	XXX
NO.	REVISION	DATE	INIT.

NOTES/LEGEND

1 THE POSITION OF POLE LINES, CONDUITS, WATERMAINS, SEWER AND OTHER UNDERGROUND AND OVERGROUND UTILITIES AND STRUCTURES IS NOT NECESSARILY SHOWN ON THE CONTRACT DRAWINGS AND, WHERE SHOWN, THE ACCURACY OF THE POSITION OF SUCH UTILITIES AND STRUCTURES IS NOT GUARANTEED. BEFORE STARTING WORK, THE CONTRACTOR SHALL INFORM HIMSELF OF THE EXACT LOCATION OF ALL SUCH UTILITIES AND STRUCTURES AND SHALL ASSUME ALL LIABILITY FOR DAMAGE TO THEM.

2 PROPERTY LINES WERE PLOTTED USING REGISTERED PLANS AND BARS LOCATED IN THE FIELD. TO VERIFY THE ACCURACY OF THESE PROPERTY LINES, A LEGAL SURVEY SHOULD BE PERFORMED PRIOR TO CONSTRUCTION.

DRAFTING
BDL
DESIGN
SMP
CHECKED BY
SMP
APPROVED BY
PAM



CASABLANCA BOULEVARD  
STA. 11+050 TO STA. 11+400  
TOWN OF GRIMSBY  
COMPOSITE UTILITY PROFILE

CONSULTANT FILE No.	18-7650
DATE	2018-10-11
SCALE	AS SHOWN
REF. No.	#
DWG No.	4B
REV.	0

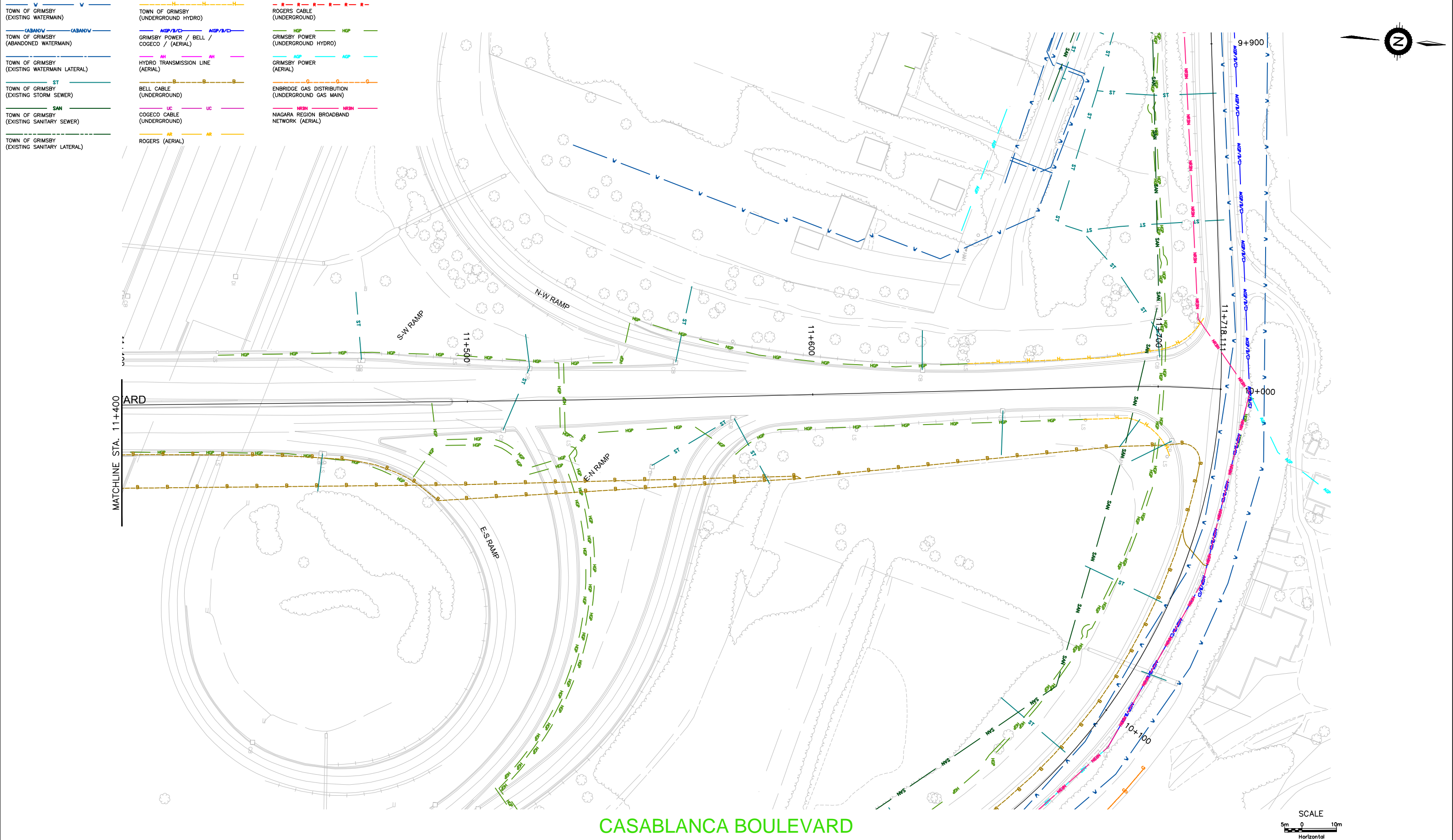

				NOTES/LEGEND		DRAFTING		<div>NiagaraRegion</div> <div>PUBLIC WORKS</div>		<div>DILLONCONSULTING</div>		CONSULTANT FILE No. 18-7650		
				1 THE POSITION OF POLE LINES, CONDUITS, WATERMAINS, SEWER AND OTHER UNDERGROUND AND OVERGROUND UTILITIES AND STRUCTURES IS NOT NECESSARILY SHOWN ON THE CONTRACT DRAWINGS AND, WHERE SHOWN, THE ACCURACY OF THE POSITION OF SUCH UTILITIES AND STRUCTURES IS NOT GUARANTEED. BEFORE STARTING WORK, THE CONTRACTOR SHALL INFORM HIMSELF OF THE EXACT LOCATION OF ALL SUCH UTILITIES AND STRUCTURES AND SHALL ASSUME ALL LIABILITY FOR DAMAGE TO THEM.		DESIGN								
				2 PROPERTY LINES WERE PLOTTED USING REGISTERED PLANS AND BARS LOCATED IN THE FIELD. TO VERIFY THE ACCURACY OF THESE PROPERTY LINES, A LEGAL SURVEY SHOULD BE PERFORMED PRIOR TO CONSTRUCTION.		CHECKED BY								
						APPROVED BY								
								<div>CASABLANCA BOULEVARD</div> <div>STA. 11+400 TO STA. 11+718</div> <div>TOWN OF GRIMSBY</div> <div>COMPOSITE UTILITY PLAN</div>						

CASABLANCA BOULEVARD

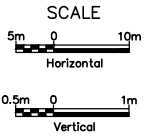
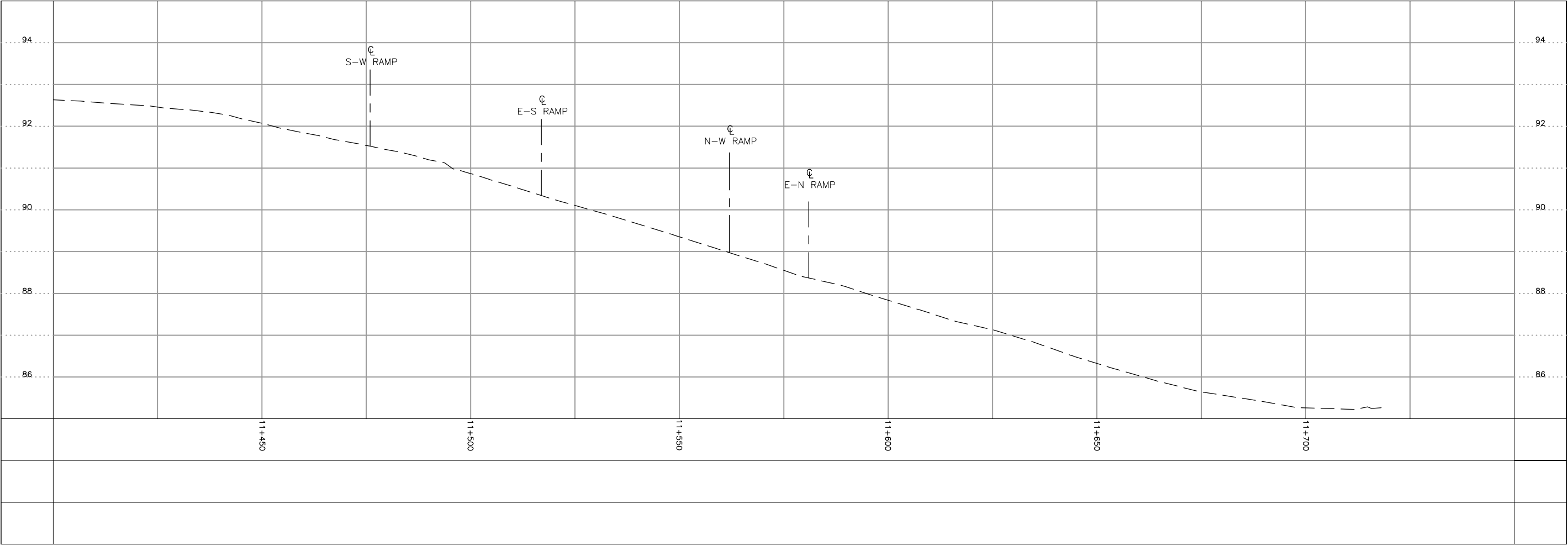

0	ISSUED FOR	YYYY-MM-DD	XXX
NO.	REVISION	DATE	INIT.

NOTES/LEGEND

1 THE POSITION OF POLE LINES, CONDUITS, WATERMAINS, SEWER AND OTHER UNDERGROUND AND OVERGROUND UTILITIES AND STRUCTURES IS NOT NECESSARILY SHOWN ON THE CONTRACT DRAWINGS AND, WHERE SHOWN, THE ACCURACY OF THE POSITION OF SUCH UTILITIES AND STRUCTURES IS NOT GUARANTEED. BEFORE STARTING WORK, THE CONTRACTOR SHALL INFORM HIMSELF OF THE EXACT LOCATION OF ALL SUCH UTILITIES AND STRUCTURES AND SHALL ASSUME ALL LIABILITY FOR DAMAGE TO THEM.

2 PROPERTY LINES WERE PLOTTED USING REGISTERED PLANS AND BARS LOCATED IN THE FIELD. TO VERIFY THE ACCURACY OF THESE PROPERTY LINES, A LEGAL SURVEY SHOULD BE PERFORMED PRIOR TO CONSTRUCTION.

DRAFTING	BDL
DESIGN	XXX
CHECKED BY	XXX
APPROVED BY	XXX



CASABLANCA BOULEVARD  
STA. 11+400 TO STA. 11+718  
TOWN OF GRIMSBY  
COMPOSITE UTILITY PROFILE

CONSULTANT FILE No.	18-7650
DATE	YYYY-MM-DD
SCALE	1:1000 1:100
REF. No.	#
DWG No.	5B
REV.	0



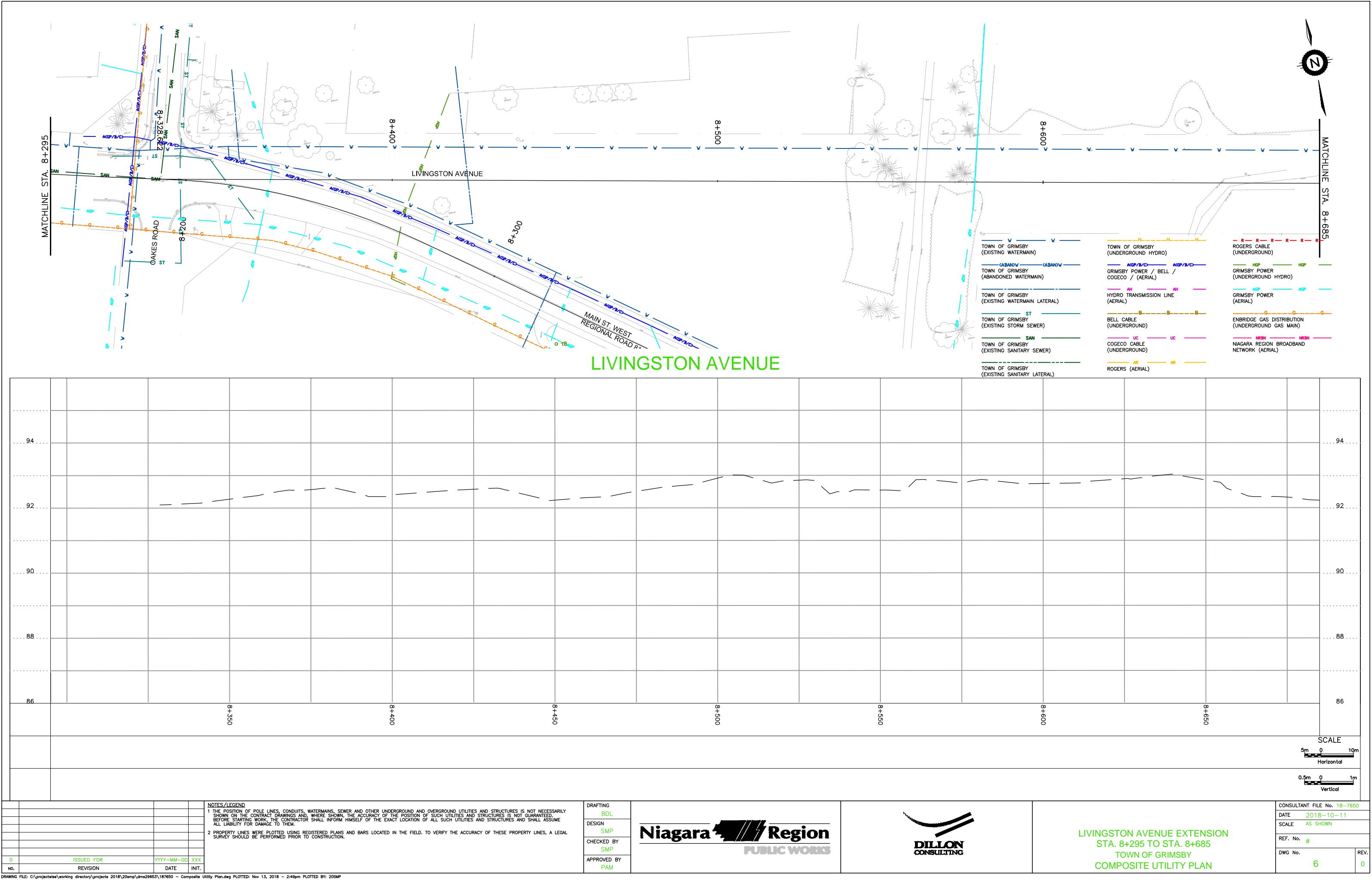

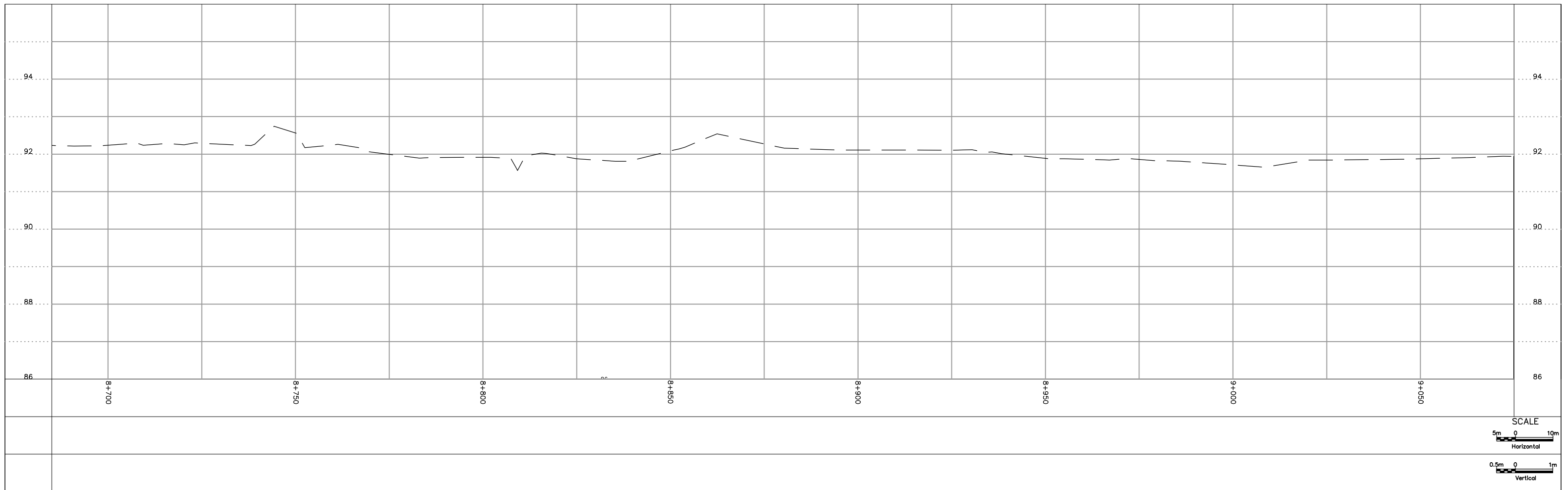
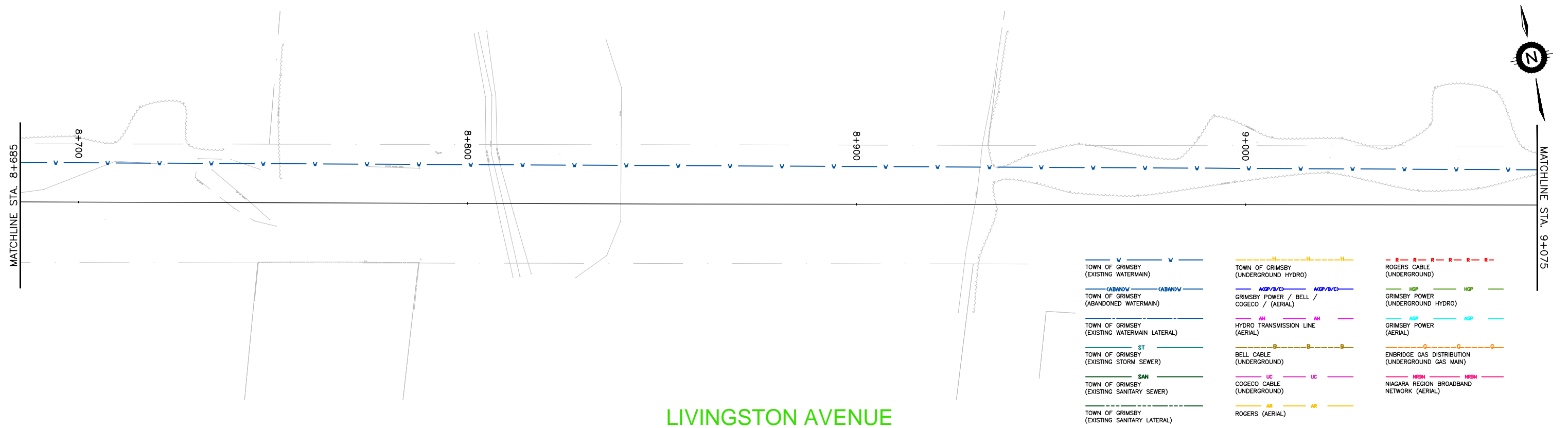

0	ISSUED FOR	YYYY-MM-DD	XXX
NO.	REVISION	DATE	INIT.

**NOTES/LEGEND**

1 THE POSITION OF POLE LINES, CONDUITS, WATERMAINS, SEWER AND OTHER UNDERGROUND AND OVERGROUND UTILITIES AND STRUCTURES IS NOT NECESSARILY SHOWN ON THE CONTRACT DRAWINGS AND, WHERE SHOWN, THE ACCURACY OF THE POSITION OF SUCH UTILITIES AND STRUCTURES IS NOT GUARANTEED. BEING AVOIDED BY THE CONTRACTOR SHALL INFORM HIMSELF OF THE EXACT LOCATION OF ALL SUCH UTILITIES AND STRUCTURES AND SHALL ASSUME ALL LIABILITY FOR DAMAGE TO THEM.

2 PROPERTY LINES WERE PLOTTED USING REGISTERED PLANS AND BARS LOCATED IN THE FIELD, TO VERIFY THE ACCURACY OF THESE PROPERTY LINES, A LEGAL SURVEY SHOULD BE PERFORMED PRIOR TO CONSTRUCTION.

DRAFTING	BDL
DESIGN	SMP
CHECKED BY	SMP
APPROVED BY	PAM



LIVINGSTON AVENUE EXTENSION  
STA. 8+685 TO STA. 9+075  
TOWN OF GRIMSBY  
COMPOSITE UTILITY PLAN

CONSULTANT FILE No. 18-7650	
DATE 2018-10-11	
SCALE AS SHOWN	
REF. No. #	
DWG No. 7	REV. 0

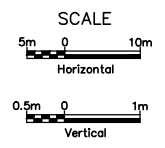
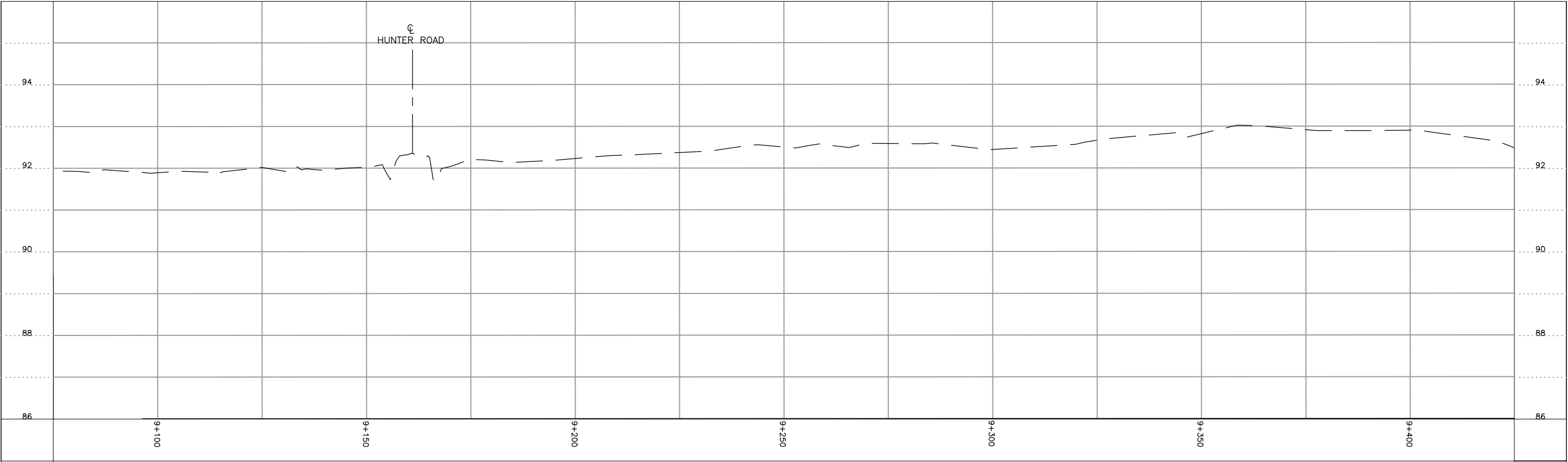
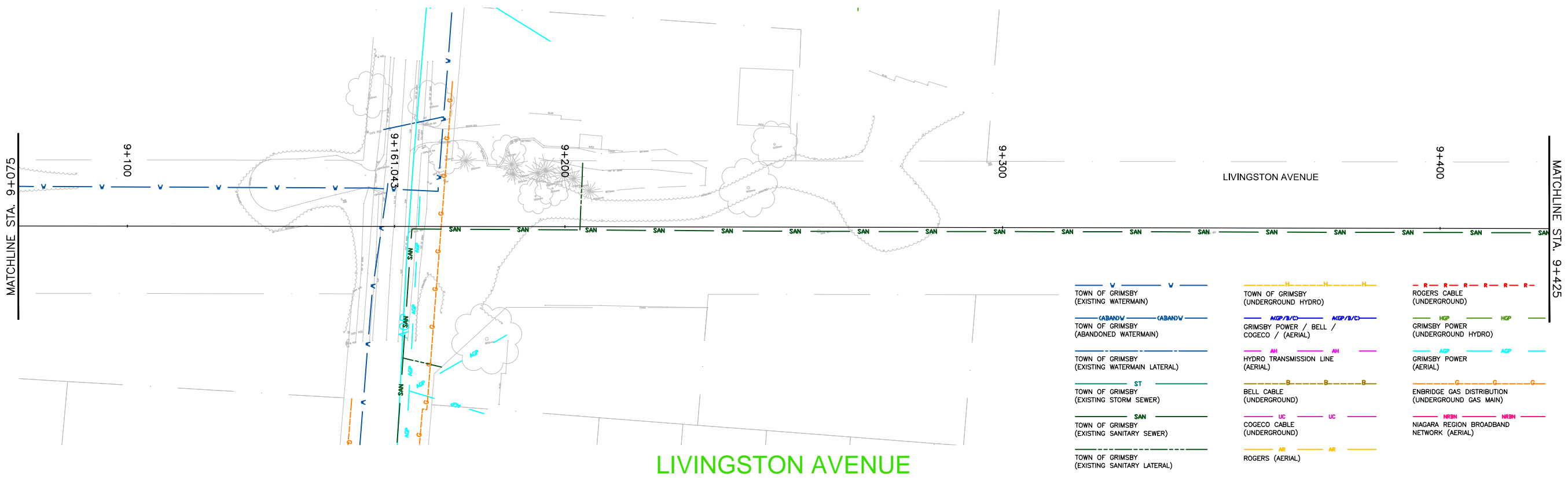

NO.	REVISION	DATE	INIT.
0	ISSUED FOR	YYYY-MM-DD	XXX

**NOTES/LEGEND**

1 THE POSITION OF POLE LINES, CONDUITS, WATERMAINS, SEWER AND OTHER UNDERGROUND AND OVERGROUND UTILITIES AND STRUCTURES IS NOT NECESSARILY SHOWN ON THE CONTRACT DRAWINGS AND, WHERE SHOWN, THE ACCURACY OF THE POSITION OF SUCH UTILITIES AND STRUCTURES IS NOT GUARANTEED. BEFORE STARTING WORK, THE CONTRACTOR SHALL INFORM HIMSELF OF THE EXACT LOCATION OF ALL SUCH UTILITIES AND STRUCTURES AND SHALL ASSUME ALL LIABILITY FOR DAMAGE TO THEM.

2 PROPERTY LINES WERE PLOTTED USING REGISTERED PLANS AND BARS LOCATED IN THE FIELD. TO VERIFY THE ACCURACY OF THESE PROPERTY LINES, A LEGAL SURVEY SHOULD BE PERFORMED PRIOR TO CONSTRUCTION.

DRAFTING	BDL
DESIGN	SMP
CHECKED BY	SMP
APPROVED BY	PAM



CONSULTANT FILE No. 18-7650	
DATE 2018-10-11	
SCALE AS SHOWN	
REF. No. #	
DWG No. 8	REV. 0



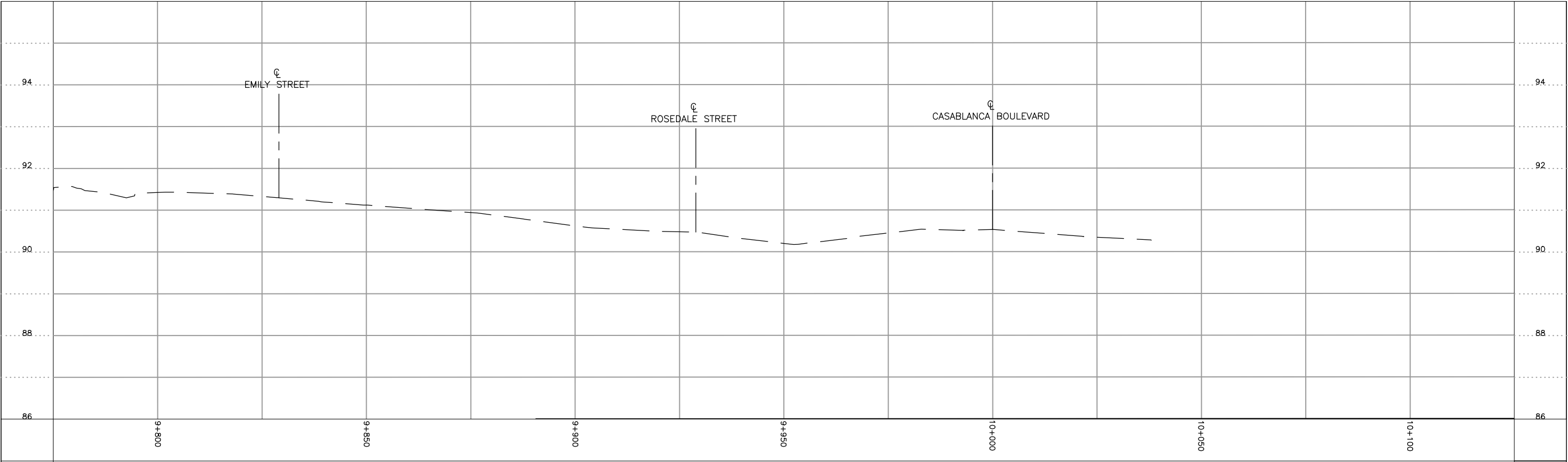
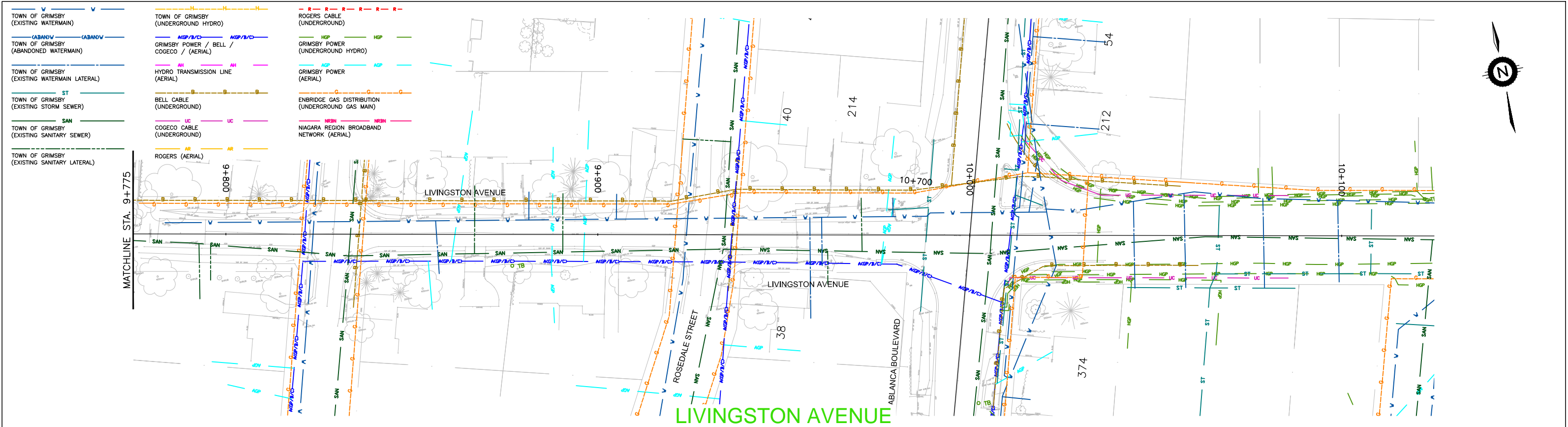

0	ISSUED FOR	XXXX-MM-DD	XXX
NO.	REVISION	DATE	INIT.

NOTES/LEGEND

1 THE POSITION OF POLE LINES, CONDUITS, WATERMAINS, SEWER AND OTHER UNDERGROUND AND OVERGROUND UTILITIES AND STRUCTURES IS NOT NECESSARILY SHOWN ON THE CONTRACT DRAWINGS AND, WHERE SHOWN, THE ACCURACY OF THE POSITION OF SUCH UTILITIES AND STRUCTURES IS NOT GUARANTEED. BEFORE STARTING WORK, THE CONTRACTOR SHALL INFORM HIMSELF OF THE EXACT LOCATION OF ALL SUCH UTILITIES AND STRUCTURES AND SHALL ASSUME ALL LIABILITY FOR DAMAGE TO THEM.

2 PROPERTY LINES WERE PLOTTED USING REGISTERED PLANS AND BARS LOCATED IN THE FIELD. TO VERIFY THE ACCURACY OF THESE PROPERTY LINES, A LEGAL SURVEY SHOULD BE PERFORMED PRIOR TO CONSTRUCTION.

DRAFTING  
BDL

DESIGN  
SMP

CHECKED BY  
SMP

APPROVED BY  
PAM

**Niagara Region**

**PUBLIC WORKS**

**DILLON CONSULTING**

LIVINGSTON AVENUE EXTENSION  
STA. 9+775 TO STA. 10+125  
TOWN OF GRIMSBY  
COMPOSITE UTILITY PLAN

CONSULTANT FILE No. 18-7650	
DATE 2018-10-11	
SCALE AS SHOWN	
REF. No. #	
DWG No. 10	REV. 0

DRAWING FILE: C:\project\working directory\projects 2018\20amp\dms29653\187650 - Composite Utility Plan.dwg PLOTTED: Nov 13, 2018 - 2:51pm PLOTTED BY: 20SMP



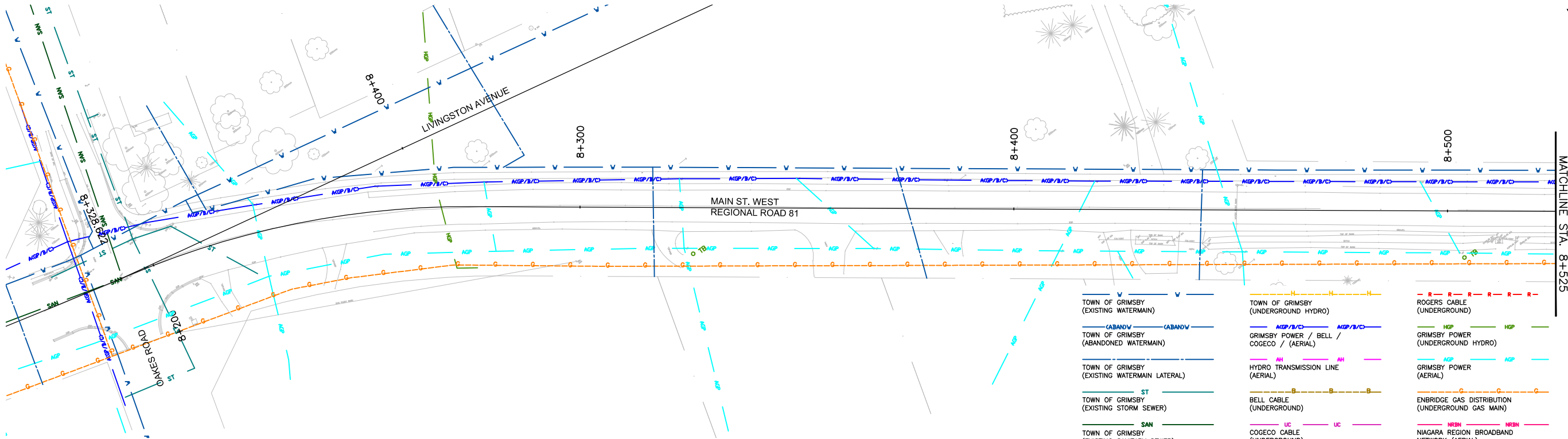

MAIN STREET WEST

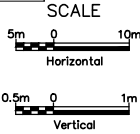
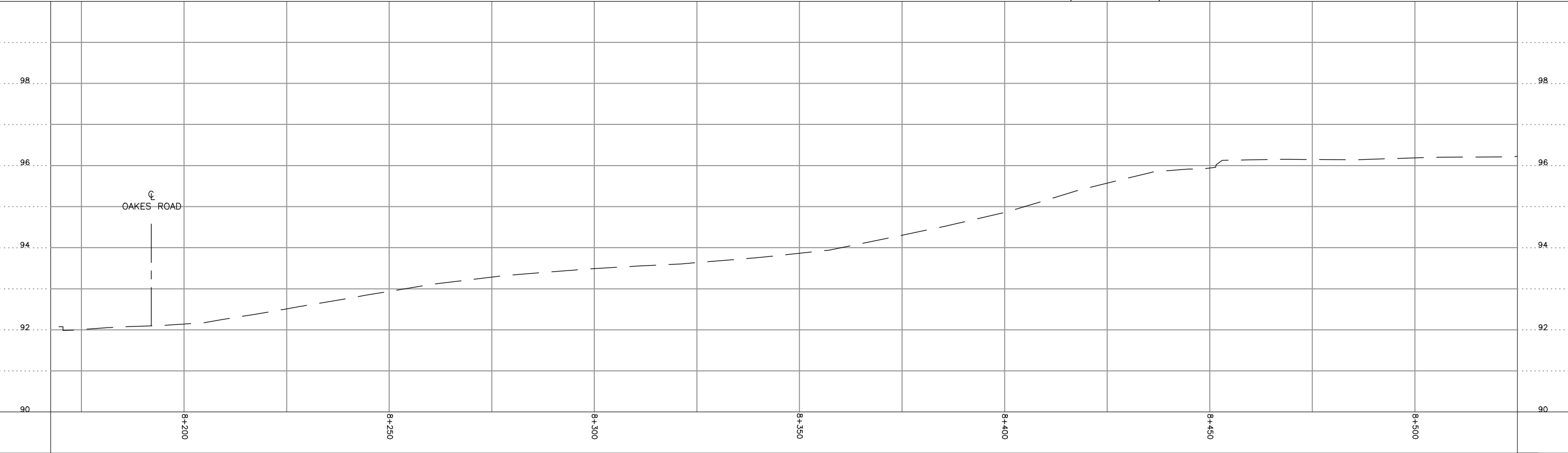

NOTES/LEGEND  
1 THE POSITION OF POLE LINES, CONDUITS, WATERMAINS, SEWER AND OTHER UNDERGROUND AND OVERGROUND UTILITIES AND STRUCTURES IS NOT NECESSARILY SHOWN ON THE CONTRACT DRAWINGS AND, WHERE SHOWN, THE ACCURACY OF THE POSITION OF SUCH UTILITIES AND STRUCTURES IS NOT GUARANTEED. BEFORE STARTING WORK, THE CONTRACTOR SHALL INFORM HIMSELF OF THE EXACT LOCATION OF ALL SUCH UTILITIES AND STRUCTURES AND SHALL ASSUME ALL LIABILITY FOR DAMAGE TO THEM.  
2 PROPERTY LINES WERE PLOTTED USING REGISTERED PLANS AND BARS LOCATED IN THE FIELD. TO VERIFY THE ACCURACY OF THESE PROPERTY LINES, A LEGAL SURVEY SHOULD BE PERFORMED PRIOR TO CONSTRUCTION.

NO.	REVISION	DATE	INIT.
0	ISSUED FOR	YYYY-MM-DD	XXX

DRAFTING	BDL
DESIGN	SMP
CHECKED BY	SMP
APPROVED BY	PAM



MAIN ST. WEST / REGIONAL ROAD 18  
STA. 8+192.006 TO STA. 8+525  
TOWN OF GRIMSBY  
COMPOSITE UTILITY PLAN

CONSULTANT FILE No.	18-7650
DATE	2018-10-11
SCALE	AS SHOWN
REF. No.	#
DWG No.	11
REV.	0

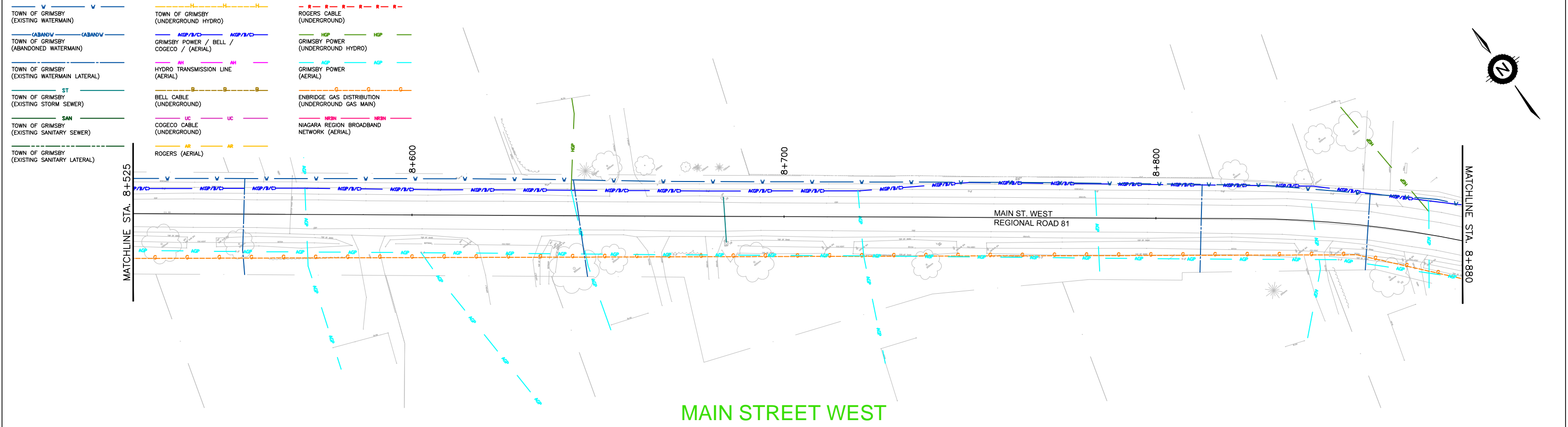

MAIN STREET WEST

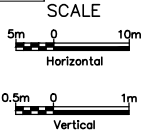
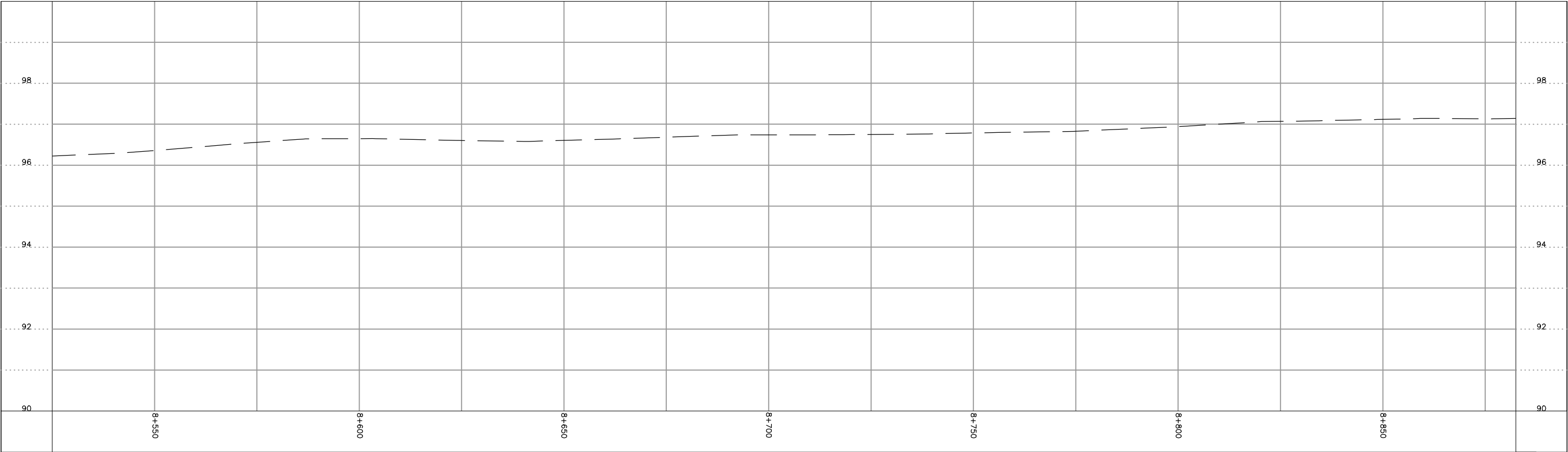

NO.	REVISION	DATE	INIT.
0	ISSUED FOR	YYYY-MM-DD	XXX

NOTES/LEGEND  
1 THE POSITION OF POLE LINES, CONDUITS, WATERMAINS, SEWER AND OTHER UNDERGROUND AND OVERGROUND UTILITIES AND STRUCTURES IS NOT NECESSARILY SHOWN ON THE CONTRACT DRAWINGS AND, WHERE SHOWN, THE ACCURACY OF THE POSITION OF SUCH UTILITIES AND STRUCTURES IS NOT GUARANTEED. BEFORE STARTING WORK, THE CONTRACTOR SHALL INFORM HIMSELF OF THE EXACT LOCATION OF ALL SUCH UTILITIES AND STRUCTURES AND SHALL ASSUME ALL LIABILITY FOR DAMAGE TO THEM.  
2 PROPERTY LINES WERE PLOTTED USING REGISTERED PLANS AND BARS LOCATED IN THE FIELD. TO VERIFY THE ACCURACY OF THESE PROPERTY LINES, A LEGAL SURVEY SHOULD BE PERFORMED PRIOR TO CONSTRUCTION.

DRAFTING	BDL
DESIGN	SMP
CHECKED BY	SMP
APPROVED BY	PAM



MAIN ST. WEST / REGIONAL ROAD 18  
STA. 8+525 TO STA. 8+880  
TOWN OF GRIMSBY  
COMPOSITE UTILITY PLAN

CONSULTANT FILE No.	18-7650
DATE	2018-10-11
SCALE	AS SHOWN
REF. No.	#
DWG No.	12
REV.	0

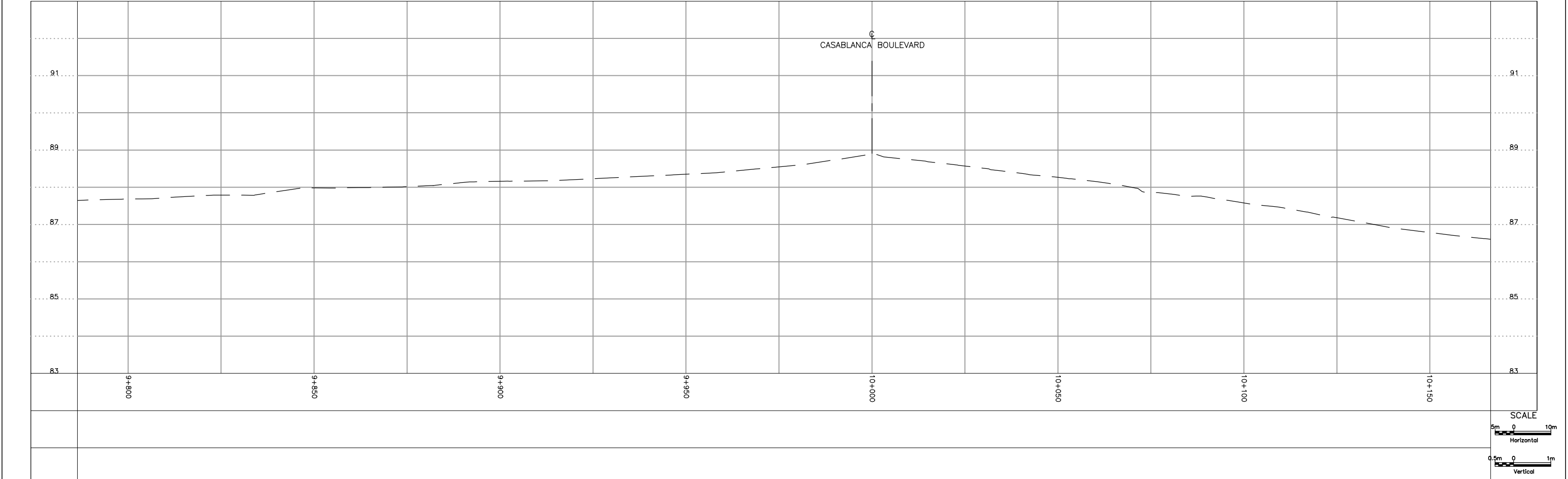
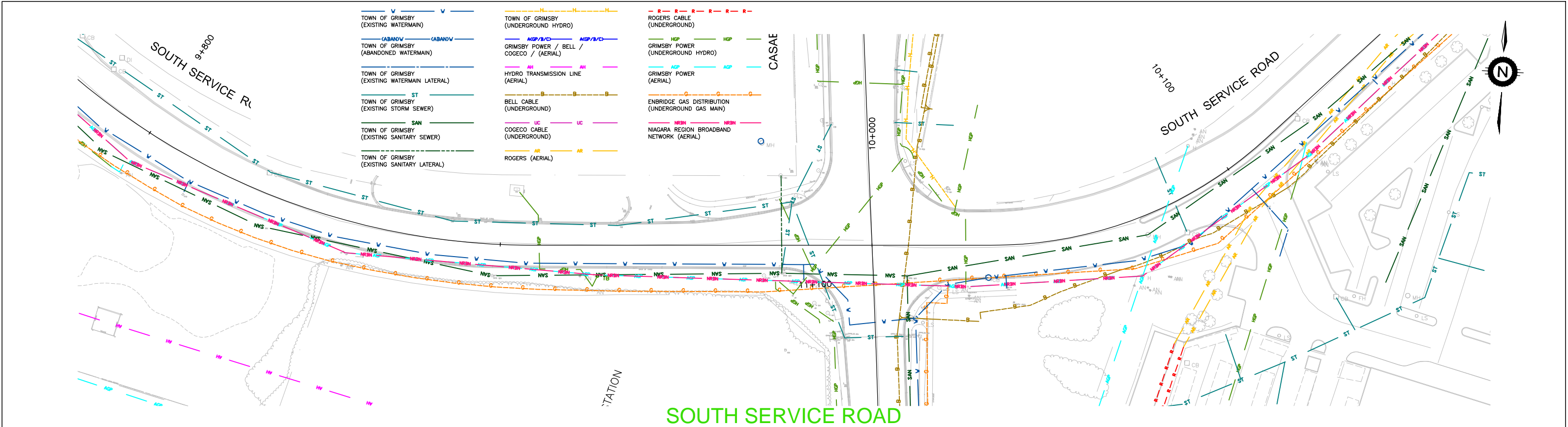

NO.	REVISION	DATE	INIT.
0	ISSUED FOR	YYYY-MM-DD	XXX

**NOTES/LEGEND**

1 THE POSITION OF POLE LINES, CONDUITS, WATERMAINS, SEWER AND OTHER UNDERGROUND AND OVERGROUND UTILITIES AND STRUCTURES IS NOT NECESSARILY SHOWN ON THE CONTRACT DRAWINGS AND, WHERE SHOWN, THE ACCURACY OF THE POSITION OF SUCH UTILITIES AND STRUCTURES IS NOT GUARANTEED. BEFORE STARTING WORK, THE CONTRACTOR SHALL INFORM HIMSELF OF THE EXACT LOCATION OF ALL SUCH UTILITIES AND STRUCTURES AND SHALL ASSUME ALL LIABILITY FOR DAMAGE TO THEM.

2 PROPERTY LINES WERE PLOTTED USING REGISTERED PLANS AND BARS LOCATED IN THE FIELD. TO VERIFY THE ACCURACY OF THESE PROPERTY LINES, A LEGAL SURVEY SHOULD BE PERFORMED PRIOR TO CONSTRUCTION.

DRAFTING  
BDL

DESIGN  
SMP

CHECKED BY  
SMP

APPROVED BY  
PAM

**Niagara Region**

PUBLIC WORKS

**DILLON CONSULTING**

**SOUTH SERVICE ROAD**

STA. 9+775.764 TO STA. 10+154.727

TOWN OF GRIMSBY

COMPOSITE UTILITY PLAN

CONSULTANT FILE No. 18-7650	
DATE 2018-10-11	
SCALE AS SHOWN	
REF. No. #	
DWG No. 13	REV. 0

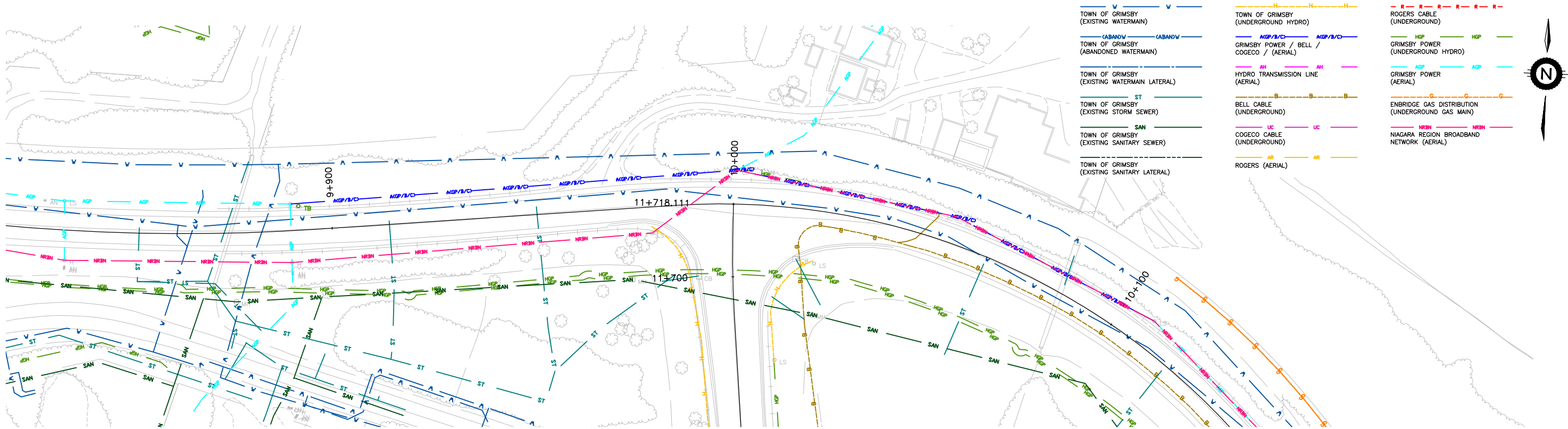

NORTH SERVICE ROAD

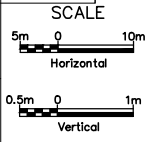
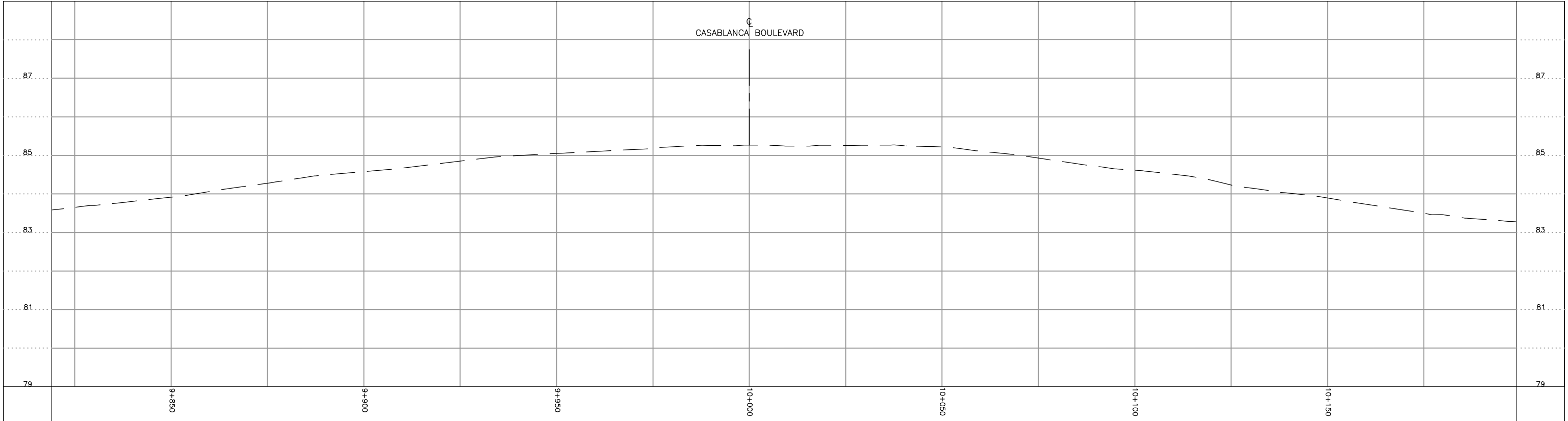

NO.	REVISION	DATE	INIT.
0	ISSUED FOR	YYYY-MM-DD	XXX

NOTES/LEGEND  
1 THE POSITION OF POLE LINES, CONDUITS, WATERMAINS, SEWER AND OTHER UNDERGROUND AND OVERGROUND UTILITIES AND STRUCTURES IS NOT NECESSARILY SHOWN ON THE CONTRACT DRAWINGS AND, WHERE SHOWN, THE ACCURACY OF THE POSITION OF SUCH UTILITIES AND STRUCTURES IS NOT GUARANTEED. BEFORE STARTING WORK, THE CONTRACTOR SHALL INFORM HIMSELF OF THE EXACT LOCATION OF ALL SUCH UTILITIES AND STRUCTURES AND SHALL ASSUME ALL LIABILITY FOR DAMAGE TO THEM.  
2 PROPERTY LINES WERE PLOTTED USING REGISTERED PLANS AND BARS LOCATED IN THE FIELD. TO VERIFY THE ACCURACY OF THESE PROPERTY LINES, A LEGAL SURVEY SHOULD BE PERFORMED PRIOR TO CONSTRUCTION.

DRAFTING	BDL
DESIGN	SMP
CHECKED BY	SMP
APPROVED BY	PAM



NORTH SERVICE ROAD  
STA. 9+818.653 TO STA.10+226.743  
TOWN OF GRIMSBY  
COMPOSITE UTILITY PLAN

CONSULTANT FILE No.	18-7650
DATE	2018-10-11
SCALE	AS SHOWN
REF. No.	#
DWG No.	14
REV.	0

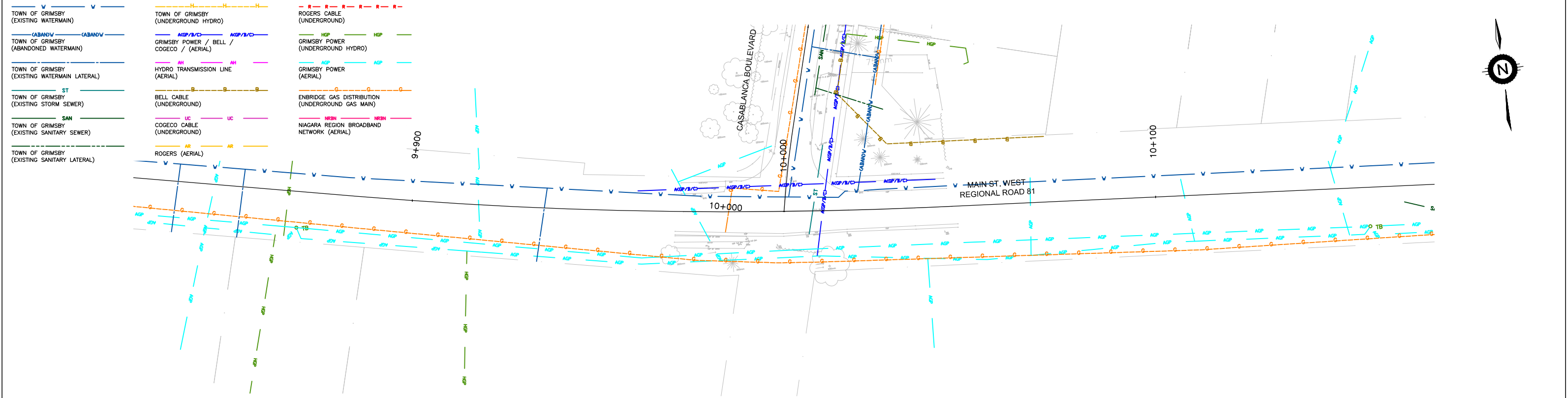

MAIN STREET WEST

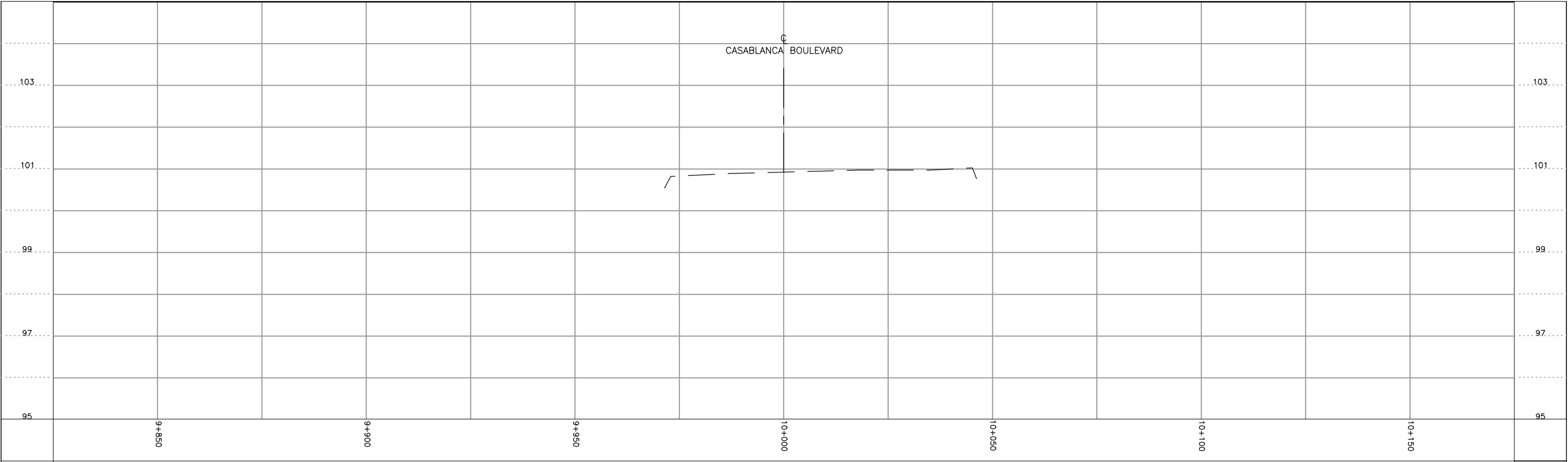

NO.	REVISION	DATE	INIT.
0	ISSUED FOR	YYYY-MM-DD	XXX

NOTES/LEGEND

1 THE POSITION OF POLE LINES, CONDUITS, WATERMAINS, SEWER AND OTHER UNDERGROUND AND OVERGROUND UTILITIES AND STRUCTURES IS NOT NECESSARILY SHOWN ON THE CONTRACT DRAWINGS AND, WHERE SHOWN, THE ACCURACY OF THE POSITION OF SUCH UTILITIES AND STRUCTURES IS NOT GUARANTEED. BEFORE STARTING WORK, THE CONTRACTOR SHALL INFORM HIMSELF OF THE EXACT LOCATION OF ALL SUCH UTILITIES AND STRUCTURES AND SHALL ASSUME ALL LIABILITY FOR DAMAGE TO THEM.

2 PROPERTY LINES WERE PLOTTED USING REGISTERED PLANS AND BARS LOCATED IN THE FIELD. TO VERIFY THE ACCURACY OF THESE PROPERTY LINES, A LEGAL SURVEY SHOULD BE PERFORMED PRIOR TO CONSTRUCTION.

DRAFTING	BDL
DESIGN	SMP
CHECKED BY	SMP
APPROVED BY	PAM

CONSULTANT FILE No. 18-7650

DATE 2018-10-11

SCALE AS SHOWN

REF. No. #

DWG No. 15

REV. 0

MAIN STREET WEST / REGIONAL ROAD 18  
STA. 9+824.674 TO STA. 10+175.156  
TOWN OF GRIMSBY  
COMPOSITE UTILITY PLAN





	TOWN OF GRIMSBY (EXISTING WATERMAIN)		TOWN OF GRIMSBY (UNDERGROUND HYDRO)		ROGERS CABLE (UNDERGROUND)
	TOWN OF GRIMSBY (ABANDONED WATERMAIN)		GRIMSBY POWER / BELL / COGECO / (AERIAL)		GRIMSBY POWER (UNDERGROUND HYDRO)
	TOWN OF GRIMSBY (EXISTING WATERMAIN LATERAL)		HYDRO TRANSMISSION LINE (AERIAL)		GRIMSBY POWER (AERIAL)
	TOWN OF GRIMSBY (EXISTING STORM SEWER)		BELL CABLE (UNDERGROUND)		ENBRIDGE GAS DISTRIBUTION (UNDERGROUND GAS MAIN)
	TOWN OF GRIMSBY (EXISTING SANITARY SEWER)		COGECO CABLE (UNDERGROUND)		NIAGARA REGION BROADBAND NETWORK (AERIAL)
	TOWN OF GRIMSBY (EXISTING SANITARY LATERAL)		ROGERS (AERIAL)		

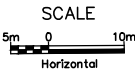
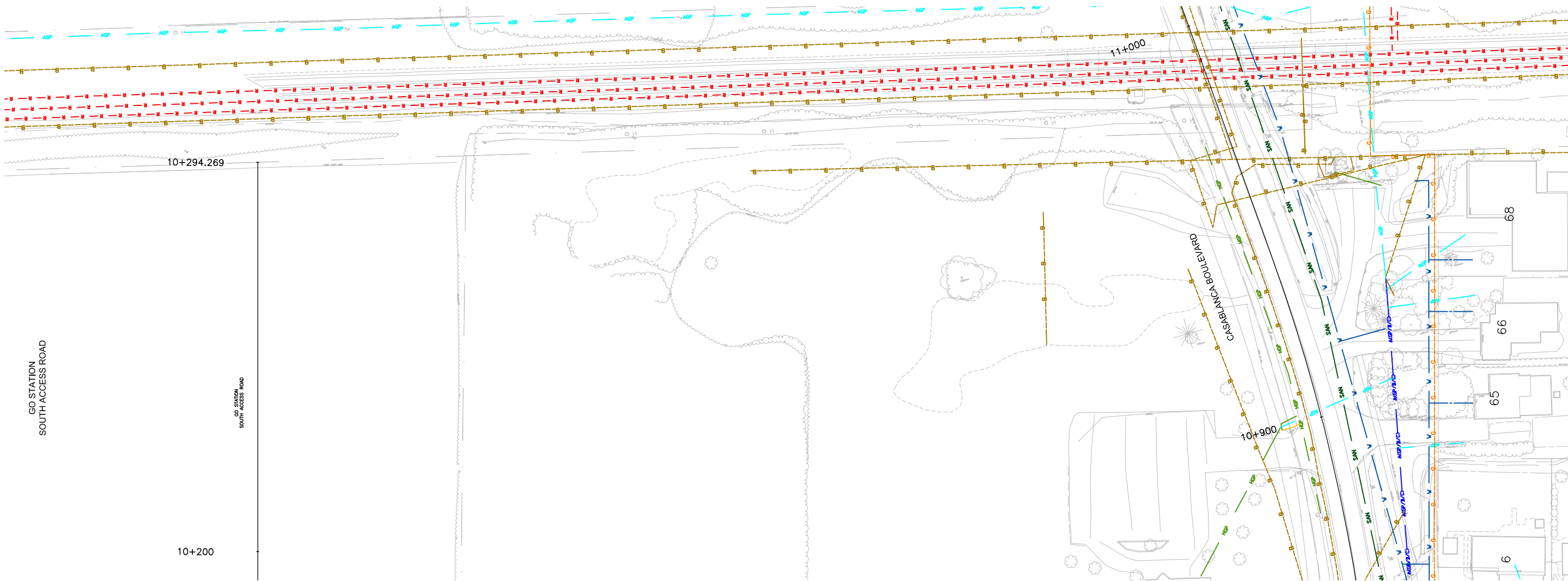

NO.	REVISION	DATE	INIT.
0	ISSUED FOR	YYYY-MM-DD	XXX

NOTES/LEGEND  
1 THE POSITION OF POLE LINES, CONDUITS, WATERMAINS, SEWER AND OTHER UNDERGROUND AND OVERGROUND UTILITIES AND STRUCTURES IS NOT NECESSARILY SHOWN ON THE CONTRACT DRAWINGS AND, WHERE SHOWN, THE ACCURACY OF THE POSITION OF SUCH UTILITIES AND STRUCTURES IS NOT GUARANTEED. BEFORE STARTING WORK, THE CONTRACTOR SHALL INFORM HIMSELF OF THE EXACT LOCATION OF ALL SUCH UTILITIES AND STRUCTURES AND SHALL ASSUME ALL LIABILITY FOR DAMAGE TO THEM.  
2 PROPERTY LINES WERE PLOTTED USING REGISTERED PLANS AND BARS LOCATED IN THE FIELD. TO VERIFY THE ACCURACY OF THESE PROPERTY LINES, A LEGAL SURVEY SHOULD BE PERFORMED PRIOR TO CONSTRUCTION.

DRAFTING	BDL
DESIGN	SMP
CHECKED BY	SMP
APPROVED BY	PAM



OLD OAFIELD ROAD  
TOWN OF GRIMSBY  
COMPOSITE UTILITY PLAN

CONSULTANT FILE No. 18-7650	
DATE 2018-10-11	
SCALE AS SHOWN	
REF. No. #	
DWG No. 17	REV. 0